

Information is given as a guide only and its accuracy cannot be guaranteed.

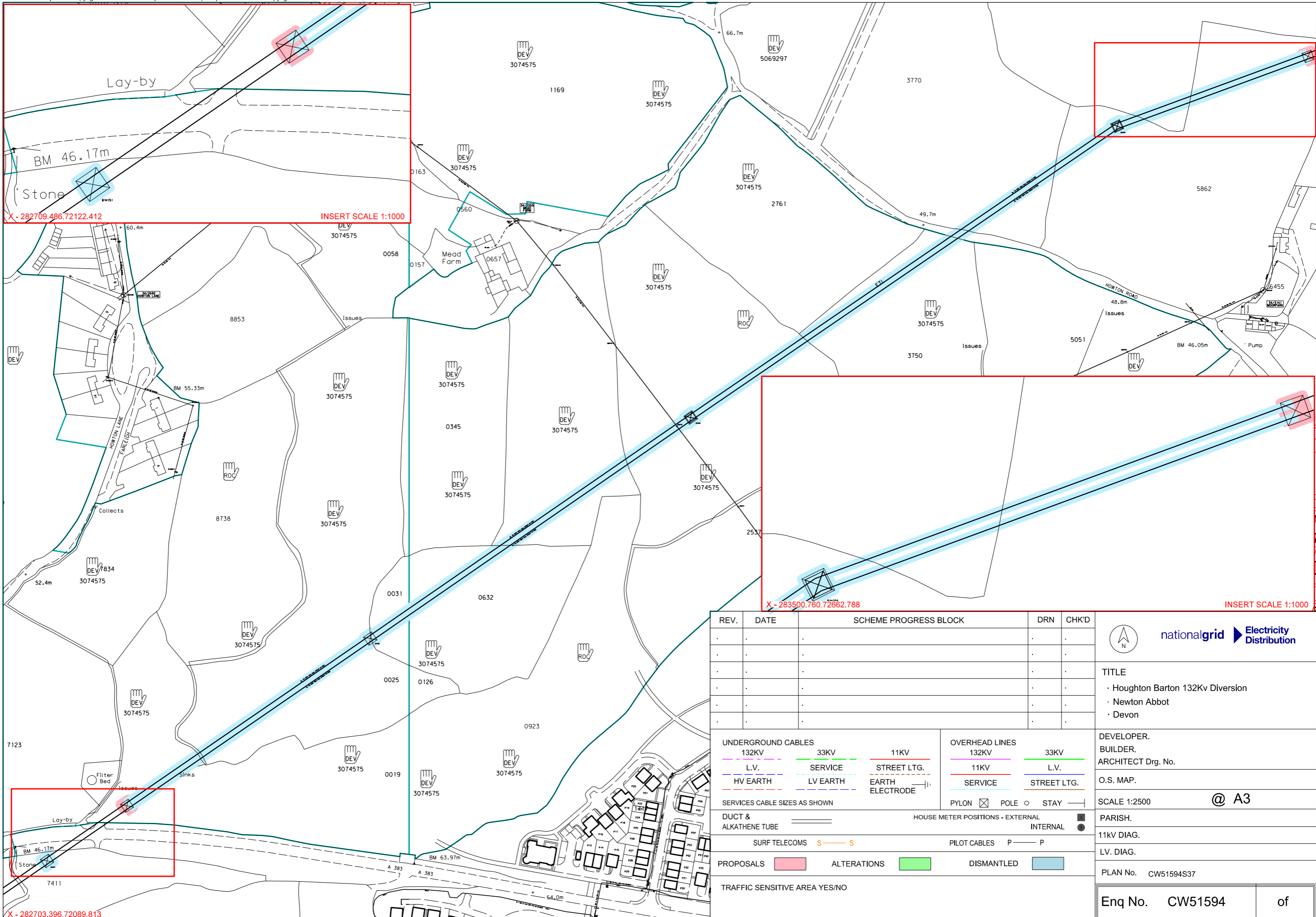

PLEASE NOTE: This plan ONLY shows assets owned by National Grid Electricity Distribution (NGED). Electricity assets owned by National Grid Electricity Transmission (NGET) and IDNO's (Independent Network Operators) MAY be present in this area.

REV.	DATE	SCHEME PROGRESS BLOCK	DRN	CHK'D

nationalgrid Electricity Distribution

TITLE

- Houghton Barton 132Kv Diversion
- Newton Abbot
- Devon

<p>UNDERGROUND CABLES</p> <p>132KV 33KV 11KV</p> <p>— L.V. — SERVICE — STREET LTG.</p> <p>— HV EARTH — LV EARTH — EARTH ELECTRODE</p> <p>SERVICES CABLE SIZES AS SHOWN</p> <p>DUCT & ALKATHENE TUBE HOUSE METER POSITIONS - EXTERNAL</p> <p>— SURF TELECOMS — S — S Pylon ☒ Pole ○ Stay —</p> <p>PILOT CABLES P — P</p> <p>PROPOSALS ALTERATIONS DISMANTLED</p> <p>TRAFFIC SENSITIVE AREA YES/NO</p>	<p>OVERHEAD LINES</p> <p>132KV 33KV</p> <p>— 11KV — L.V.</p> <p>— SERVICE — STREET LTG.</p> <p>INTERNAL</p>
--	---

DEVELOPER.	@ A3
BUILDER.	
ARCHITECT Drg. No.	
O.S. MAP.	
SCALE 1:2500	
PARISH.	
11KV DIAG.	
LV. DIAG.	
PLAN No. CW51594S37	
Enq No. CW51594	of